

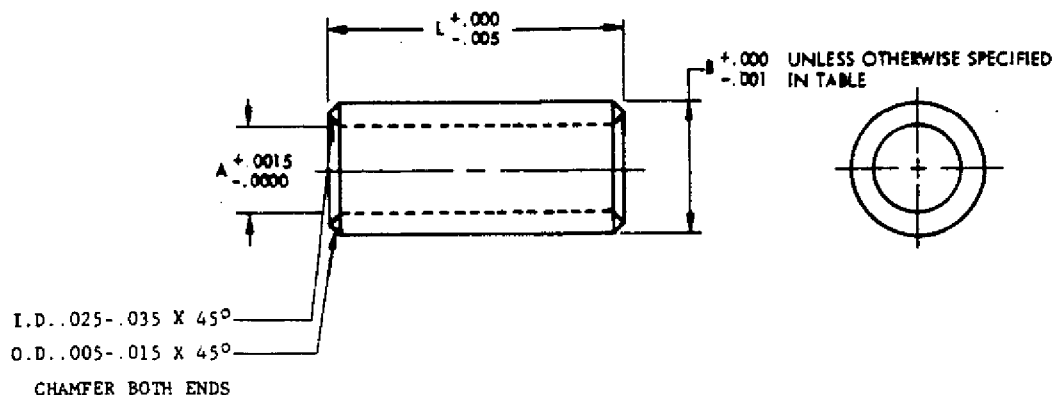

STANDARDS SHEET



SIZE DASH NO.	BOLT SIZE (REF.)	A DIA.	B DIA.
-3	#10	.190	.3295 $\begin{smallmatrix} +.0000 \\ -.0005 \end{smallmatrix}$
-4	1/4	.250	.3920 $\begin{smallmatrix} +.0000 \\ -.0005 \end{smallmatrix}$
-5	5/16	.3125	.4546 $\begin{smallmatrix} +.0000 \\ -.0005 \end{smallmatrix}$
-6	3/8	.375	.5173 $\begin{smallmatrix} +.0000 \\ -.0007 \end{smallmatrix}$
-7	7/16	.4375	.5799 $\begin{smallmatrix} +.0000 \\ -.0007 \end{smallmatrix}$
-8	1/2	.500	.6425 $\begin{smallmatrix} +.0000 \\ -.0008 \end{smallmatrix}$
-9	9/16	.5625	.7052
-10	5/8	.625	.8303
-11	-	.6875	.8929
-12	3/4	.750	.9554
-14	7/8	.875	1.0961
-16	1	1.000	1.2212
-18	1-1/8	1.125	1.3464
-20	1-1/4	1.250	1.4715

DRAWN	P LAM	CLASSIFICATION	STANDARD
CHECKED	KROMKAMP	Bushing - Plain - Oversize, Repair	CSP 438 1 of 2
STRESSED			
APPROVED			

22 MARCH 89



STANDARDS SHEET

MATERIAL:

ALLOY STEEL HEAT TREATED TO 125,000 TO 145,000 PSI MAY BE MADE FROM 4130 STEEL BAR, SPEC. MIL-S-6758, 8630 STEEL BAR, SPEC. MIL-S-6050 OR EQUIVALENT. SEAMLESS ALLOY STEEL TUBING MAY BE USED AS AN OPTIONAL MATERIAL PROVIDED THE FINISHED PRODUCT MEETS ALL OTHER REQUIREMENTS OF THIS DRAWING.

ALUMINUM BRONZE BAR, SPEC. MIL-B-6946 OR QQ-C-465, ALLOY 642, OR PER AMS 4640.

BERYLLIUM COPPER SPEC. QQ-C-530, CONDITION H.T.

FINISH:

CADMIUM PLATING PER QQ-P-416, TYPE II, CLASS 2.

CODE:

FIRST DASH ("") AFTER BASIC NUMBER INDICATES ALLOY STEEL, CADMIUM PLATED.
SECOND DASH NUMBER INDICATES LENGTH IN INCHES AND 1/32 INCH INCREMENTS.

ADD "A" AFTER BASIC NUMBER FOR ALUMINUM BRONZE.

ADD "B" AFTER BASIC NUMBER FOR BERYLLIUM COPPER.

ADD "P" AFTER SECOND DASH NUMBER FOR CADMIUM PLATED, ALL SURFACES.

ADD "N" AFTER SECOND DASH NUMBER FOR CADMIUM PLATED OUTSIDE SURFACES ONLY AND NO PLATING INSIDE DIAMETER (ID).

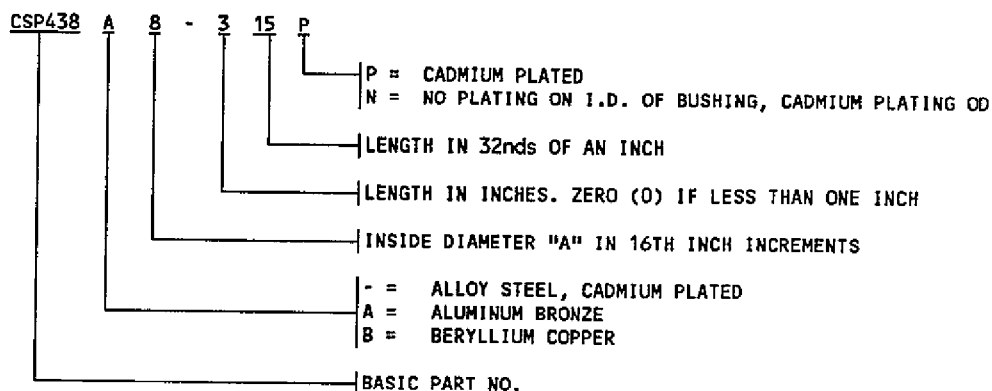
EXAMPLE OF
PART NUMBERS:

EXAMPLES:

CSP438-8-012 = CAD PLATED STEEL BUSHING, .500 INSIDE DIA., 12/32 LONG

CSP438A8-315 = AL. BRONZE BUSHING, .500 INSIDE DIA. 3 & 15/32 INCHES LONG, NO PLATING

CSP438A8-009P = AL. BRONZE BUSHING, .500 INSIDE DIA. 9/32 OF AN INCH LONG, CAD. PLATED ALL SURFACES

CSP438B8-108N = BERYLLIUM COPPER BUSHING, .500 INSIDE DIA., 1 & 8/32 INCHES LONG, CAD. PLATING O.D., NO PLATING I.D.

CSP438B8-116P = BERYLLIUM COPPER BUSHING, .500 INSIDE DIA. .500 INCH DIA. 1 & 8/32 INCHES LONG, CAD. PLATED ALL SURFACES

NOTES:

1. ALL DIMENSIONS TO BE MET AFTER PLATING.
2. ID AND OD TO BE CONCENTRIC WITHIN .003 FULL INDICATOR MOVEMENT.
3. DIMENSIONS IN INCHES. ANGULAR TOLERANCE $\pm 5^\circ$.
4. THESE BUSHINGS NOT INTENDED FOR REAMING ON ASSEMBLY. HOWEVER, REAMING OF NON-FERROUS BUSHINGS IS PERMISSIBLE IF REQUIRED.
5. SURFACE TEXTURE 125 MICRO-INCH RHR OR BETTER PER ANSI B46.1
6. BREAK SHARP EDGES .005 TO .025.
7. USAGE OF REPAIR BUSHING SHALL ONLY BE AUTHORIZED BY LIAISON ENGINEERING.
8. SEE DS108 FOR INSTALLATION INFORMATION.

DRAWN	P. LAM	CLASSIFICATION	STANDARD
CHECKED	KROMKAMP	Bushing - Plain - Oversize, Repair	CSP 438 2 of 2
STRESSED	Sub		
APPROVED	M. J. White		

22 MARCH 89