

THE INFORMATION, TECHNICAL DATA AND DESIGNS DISCLOSED IN THIS DOCUMENT (THE "INFORMATION") ARE EITHER THE EXCLUSIVE PROPERTY OF DE HAVILLAND INC., OR ARE SUBJECT TO PROPRIETARY RIGHTS OF OTHERS. THE INFORMATION IS NOT TO BE USED FOR DESIGN OR MANUFACTURE, OR DISCLOSED TO OTHERS WITHOUT THE EXPRESS PRIOR WRITTEN CONSENT OF DE HAVILLAND INC.

de HAVILLAND

**CAGE CODE 71867
CSP STANDARD**

THE HOLDER OF THIS DOCUMENT, BY ITS RETENTION AGREES TO HOLD THE INFORMATION IN CONFIDENCE. THESE RESTRICTIONS DO NOT APPLY TO PERSONS HAVING PROPRIETARY RIGHTS IN THE INFORMATION, TO THE EXTENT OF THOSE RIGHTS

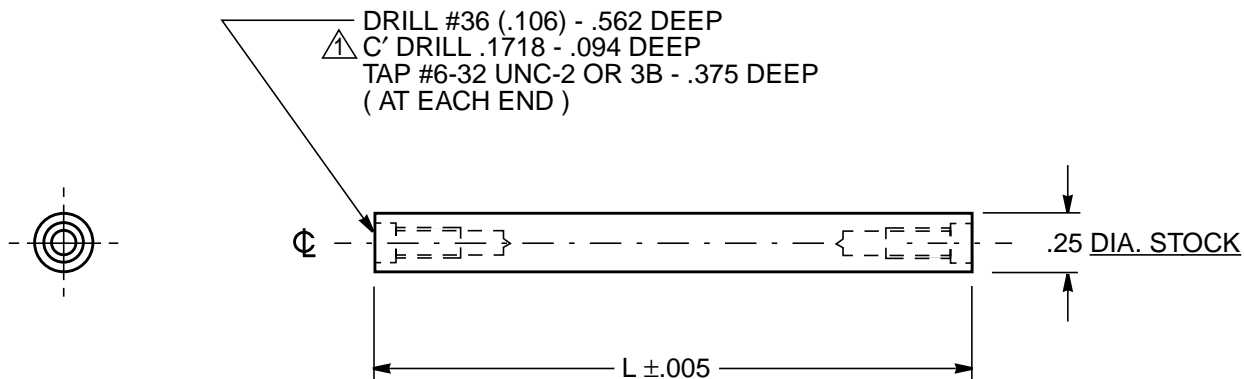

CSP529 SPACER , ELECTRICAL RECEPTACLE

DASH NO.	L	DASH NO.	L	DASH NO.	L	DASH NO.	L
- 1	0.75	- 11	3.25	- 22	6.00	- 33	5.375
- 2	1.00	- 12	3.50	- 23	6.25	- 34	3.33
- 3	1.25	- 13	3.75	- 24	6.50	- 35	1.68
- 4	1.50	- 14	4.00	- 25	6.75	- 36	2.62
- 5	1.75	- 15	4.25	- 26	7.00	- 37	2.60
- 6	2.00	- 16	4.50	- 27	7.25	- 38	2.55
- 7	2.25	- 17	4.75	- 28	7.50	- 39	2.80
-7 1/2	2.38	- 18	5.00	- 29	7.75	- 40	4.15
- 8	2.50	- 19	5.25	- 30	8.00	- 41	3.40
- 9	2.75	- 20	5.50	- 31	4.40	- 42	3.90
- 10	3.00	- 21	5.75	- 32	2.84		

SEE ENGINEERING STANDARDS APPROVAL RECORD FOR ORIGINAL SIGNATURES AND CHANGE SUMMARY

DRAWN	E. DANESH	SPACER ELECTRICAL RECEPTACLE	CSP 529
CHECKED	B.EDWARDS		
STRESSED	E. GIOVANNETTI		SHEET: 1 of 2
APPROVED	B. EDWARDS		

REV:

REV:

REV:

REV:

REV:

REV:

APPROVED: 23 JUL 2009

THE INFORMATION, TECHNICAL DATA AND DESIGNS DISCLOSED IN THIS DOCUMENT (THE "INFORMATION") ARE EITHER THE EXCLUSIVE PROPERTY OF DE HAVILLAND INC., OR ARE SUBJECT TO PROPRIETARY RIGHTS OF OTHERS. THE INFORMATION IS NOT TO BE USED FOR DESIGN OR MANUFACTURE, OR DISCLOSED TO OTHERS WITHOUT THE EXPRESS PRIOR WRITTEN CONSENT OF DE HAVILLAND INC.

de HAVILLAND
CAGE CODE 71867
CSP STANDARD

THE HOLDER OF THIS DOCUMENT, BY ITS RETENTION AGREES TO HOLD THE INFORMATION IN CONFIDENCE. THESE RESTRICTIONS DO NOT APPLY TO PERSONS HAVING PROPRIETARY RIGHTS IN THE INFORMATION, TO THE EXTENT OF THOSE RIGHTS

MATERIAL: 2024-T4 ROD PER AMS-QQ-A-225/6
FINISH: CHEMICAL CONVERSION COAT PER MIL-C-5541 , CLASS 3

- NOTES:**
- 1. CHAMFER EDGE OF C'DRILL HOLE .015 x 45°
 - 2. DRILL THROUGH IN -1, -2 & -3. THREAD FULL LENGTH IN -1.
 - 3. ALL DIMENSIONS ARE IN INCHES
 - 4. TOLERANCES UNLESS OTHERWISE SPECIFIED: .XX ±.03
.XXX ±.010

EXAMPLE OF PART NUMBER:

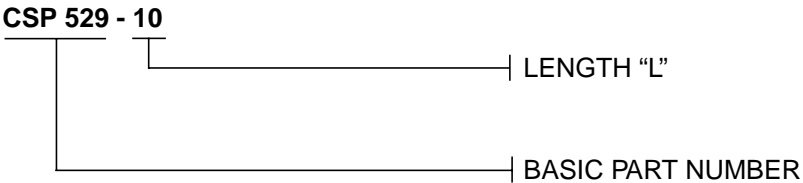

SEE ENGINEERING STANDARDS APPROVAL RECORD FOR ORIGINAL SIGNATURES AND CHANGE SUMMARY

DRAWN	E. DANESH	SPACER ELECTRICAL RECEPTACLE	CSP 529
CHECKED	B.EDWARDS		
STRESSED	E. GIOVANNETTI		SHEET: 2 of 2
APPROVED	B. EDWARDS		

REV:

REV:

REV:

REV:

REV:

REV:

APPROVED: 23 JUL 2009