

de HAVILLAND

CAGE CODE 71867
CV STANDARD

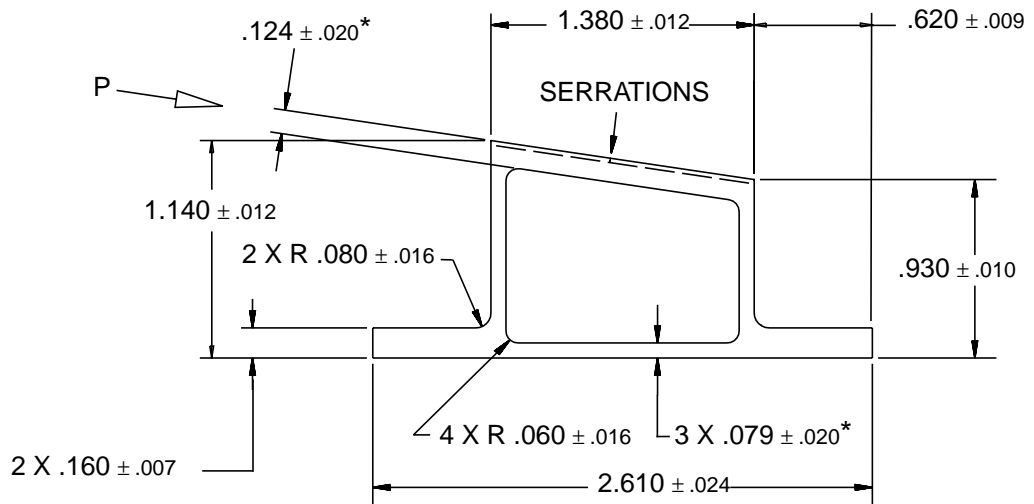
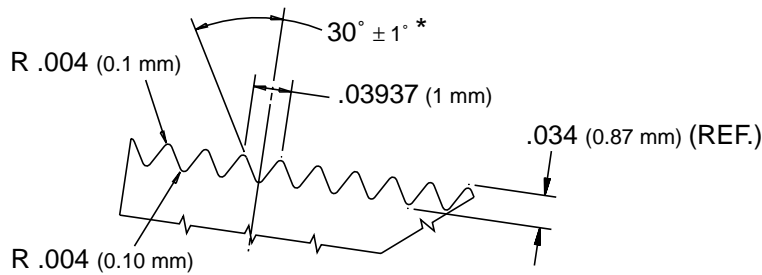

EXTERNAL RAD = .016

MATERIAL: ALUMINUM ALLOY 7075-T73/T73511
SPECIFICATION: QQ-A-200/11
UNLESS OTHERWISE STATED FED. STD #245 TOLERANCES APPLY

MINIMUM EXTRUSION LENGTH - 18 FEET

NOTES:

- 1) SPECIAL TOLERANCES ARE MARKED WITH AN ASTERISK (*).
- 2) THE EXTRUSION SHALL BE MARKED WITH THE CV # EVERY 3 FEET. **MARKING METHOD SHALL NOT HAVE A DETRIMENTAL EFFECT ON THE MATERIAL**
- 3) WEIGHT: 0.750 LB/FT
- 4) SERRATIONS TO MATCH A MATING COMPONENT WITH METRIC SERRATIONS. DETAILS AS FOLLOWS:
 1. 1 MILLIMETER (mm) PITCH
 2. INDIVIDUAL PITCH ERROR (TOOTH TO TOOTH) OF ± 0.1 mm *
 3. CUMULATIVE PITCH ERROR OF ± 0.2 mm OVER 5 CENTIMETERS (cm) *

FOR ORIGINAL SIGNATURES, SEE THE ENGINEERING STANDARDS APPROVAL RECORD

DRAWN	J. ROTSCH	BIN RAIL EXTRUSION	CV 838
CHECKED	B. McDONALD		
STRESSED	P. IAKOVLEV		
APPROVED	S. HAMID		
DATE: 14 JAN 98		REVISION: -	

THE INFORMATION, TECHNICAL DATA AND DESIGNS DISCLOSED IN THIS DOCUMENT (THE "INFORMATION") ARE EITHER THE EXCLUSIVE PROPERTY OF DE HAVILLAND INC., OR ARE SUBJECT TO PROPRIETARY RIGHTS OF OTHERS. THE INFORMATION IS NOT TO BE USED FOR DESIGN OR MANUFACTURE, OR DISCLOSED TO OTHERS WITHOUT THE EXPRESS PRIOR WRITTEN CONSENT OF DE HAVILLAND INC. THE HOLDER OF THIS DOCUMENT, BY ITS RETENTION AND USE, AGREES TO HOLD THE INFORMATION IN CONFIDENCE. THESE RESTRICTIONS DO NOT APPLY TO PERSONS HAVING PROPRIETARY RIGHTS IN THE INFORMATION, TO THE EXTENT OF THOSE RIGHTS.