

**SOURCE CONTROL DRAWING**

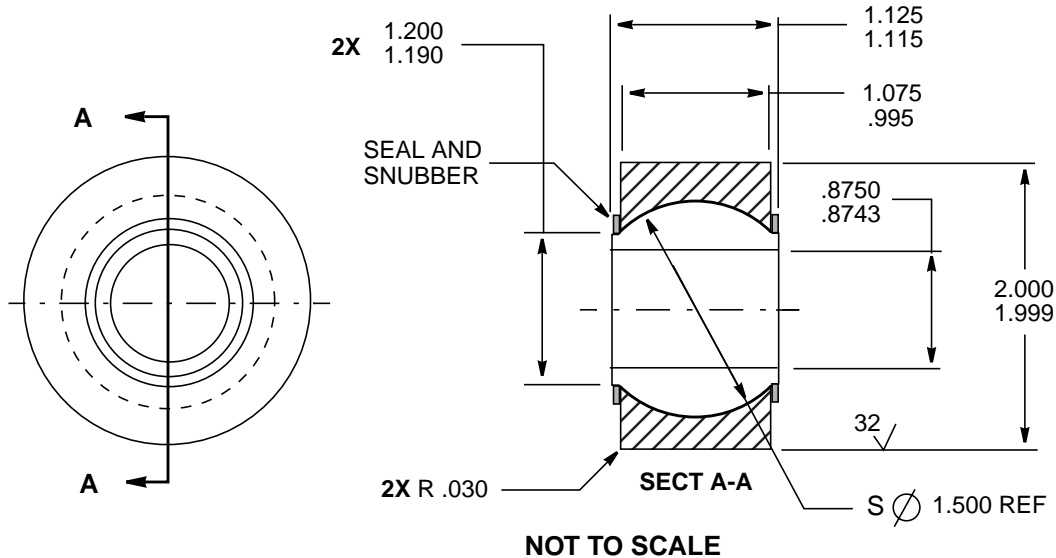

**A**

**NOTES:**

1. MAX. RADIAL PLAY: .003
2. MAX. AXIAL PLAY: .015
3. MAX. MISALIGNMENT:  $\pm 3^\circ$
4. BEARING REQUIREMENTS
  - RADIAL STATIC LOAD: 12000 LBS
  - AXIAL STATIC LOAD: 1500 LBS
  - RADIAL DYNAMIC LOAD: 11750 LBS FOR 10000 CYCLES (10 REVOLUTIONS PER CYCLE)
  - ENVIRONMENT: DESERT SAND
  - OPERATING TEMPERATURE: -65°F to 160°F
5. BEARING SHALL REMAIN COMPLETELY SERVICEABLE THROUGHOUT ENTIRE LIFE OF 10000 CYCLES
6. BEARING NO-LOAD ROTATIONAL TORQUE SHALL REMAIN 5 IN-LBS MAX. THROUGHOUT ENTIRE OPERATING TEMPERATURE RANGE

**LIST OF CURRENT SHEETS**

SHEET	1	2								
REV	A	A								

FOR ORIGINAL SIGNATURES SEE THE ENGINEERING STANDARDS APPROVAL RECORD

DRAWN	B. McDonald
CHECKED	J. Johnston
STRESS	E. Berzonis
APPROVED	S. Hamid

**TITLE:**  
**BEARING, SELF-ALIGNING,**  
**SEALED, FLAT O.D., FLAP TRACK**

**DSC 515**  
 PAGE 1 OF 2  
 12 MAR 97  
 Revision: A

NOTES CLARIFIED  
 12 MAR 97 - B. McDONALD

**A**

**SOURCE CONTROL DRAWING**

**7. MATERIALS:**

OUTER RACE: CRES PER AMS 5617 (CUSTOM 455) Rc 47 MIN.

BALL: CRES PER AMS 5629 (PH13-8MO) H1000 COND

LINER: MIL-B-8943

SEALS/SNUBBERS: PTFE ELASTOMER

**8. APPLICATION: FLAP TRACK ROLLER**

**9. PROCUREMENT DEPT SHALL SPECIFY THE DSC AND MANUFACTURERS PART NUMBER ON THE PURCHASE ORDER.**

**10. REQUIREMENTS - UNLESS OTHERWISE SPECIFIED**

GENERAL:

DIMENSIONS ARE IN INCHES

SURFACE ROUGHNESS 125  $\sqrt{\text{ }}$  MAX

LIMITS:

DECIMALS: 3 PLACE  $\pm .010$

ANGULAR TOLERANCE:  $\pm 0^{\circ} 30'$

DHI PART NO	APPROVED VENDOR
DSC 515-1	KAMATICS CORP P/N KRP183614VT

**VENDORS:**

KAMATICS CORPORATION, BLOOMFIELD CONNECTICUT

NOTES CLARIFIED  
12 MAR 97 - B. McDONALD

A

FOR ORIGINAL SIGNATURES SEE THE ENGINEERING STANDARDS APPROVAL RECORD

DRAWN	B. McDonald	<b>TITLE:</b> <b>BEARING, SELF-ALIGNING,</b> <b>SEALED, FLAT O.D., FLAP TRACK</b>	<b>DSC 515</b> PAGE 2 OF 2 12 MAR 97 Revision: A
CHECKED	J. Johnston		
STRESS	E. Berzonis		
APPROVED	S. Hamid		